



GIS-TP1

Access code Ticket Printer for use with
Guest Internet Hotspot Gateway



- Low cost solution to print guest tickets with access codes
- The printer is a robust model designed for point of sale terminals and prints on 58mm thermal paper that can be purchased anywhere
- The printer connects directly to any GIS gateway using Ethernet cable
- The ticket access code to be printed is selected using a tablet touch display connected to the GIS gateway
- Any tablet can be used for ticket selection: from a 7inch Android tablet to an iPad
- The ticket access can be selected from one of ten options, and access code duration can be selected from 30 minutes to 180 days
- The printer can be used in conjunction with a point of sale terminal or standalone

Operation of Internet WiFi Hotspots

Many Internet WiFi Hotspots are configured so that the user has to type an access code to be connected to the Internet.

This procedure prevents unauthorized users from getting Internet access. Guest Internet gateways have a page to generate access codes which can be downloaded to a spreadsheet and printed on labels. GIS gateways also have an application program interface (API) that allows point of sale (PoS) systems to request an access code and print the code on the PoS ticket printer.

The GIS-TP1 now provides an alternative to print access codes on demand when the user requests a code.

This greatly simplifies the management of access codes as it is no longer necessary to generate a large number of codes and then print codes using a computer.

A hotel reception desk or concierge can now print access codes for guests.

A coffee bar can print access codes for guests when purchases are made.

Codes are printed using the touch screen of a tablet computer. This can be a low cost Android tablet with a 7inch display screen, or an Apple iPad tablet. Ten access codes can be pre-configured and appear as buttons on the screen of the tablet computer.

Plug and Play Installation

Like all Guest Internet gateway products, the ticket printer is very easy to install and operate.

The ticket printer should be connected to a LAN port of the GIS gateway using a switch. Wireless access points will also be connected to the GIS gateway using the same switch.

Next, the ticket printer is configured using the GIS administrator page to select up to ten access code durations as ticket options.

A new login password is also created for the tablet computer login.

Finally, the tablet computer wireless should be connected to the GIS gateway via the wireless access point. Open the browser and use the ticket printer login. The ticket select buttons are then displayed on the screen.



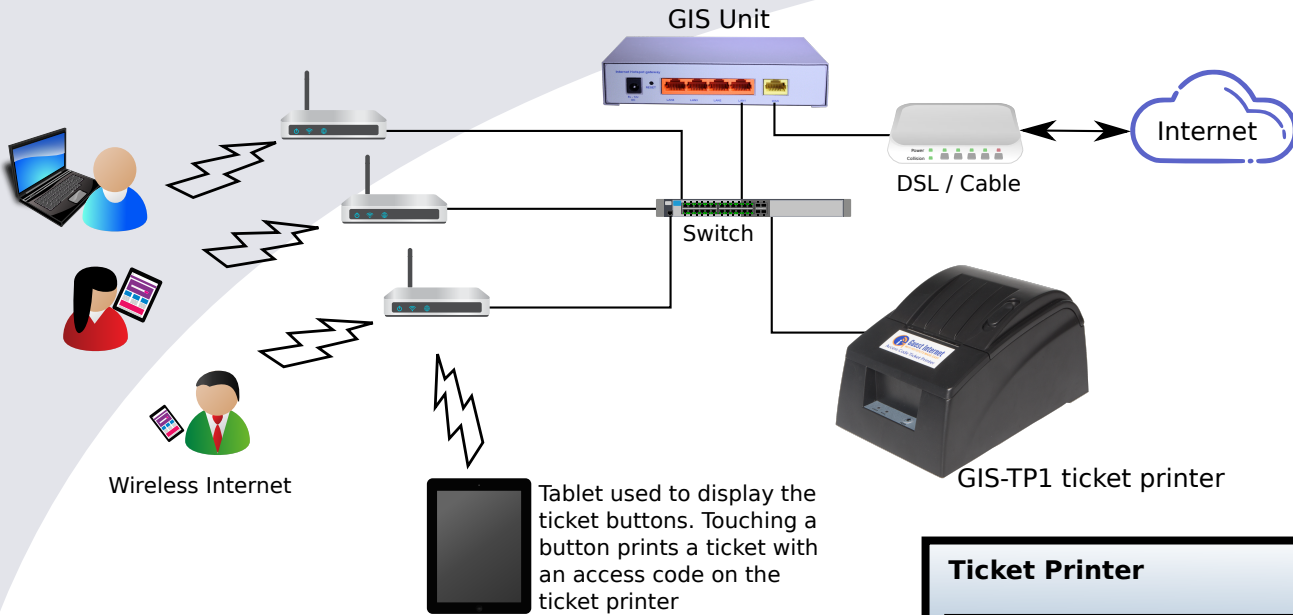

Ticket Printer

Internet Access

Internet 30 mins	Internet 1 hour	Internet 2 hours	Internet 5 hours	Internet 8 hours
Internet 1 day	Internet 2 days	Internet 5 days	Internet 1 week	Internet 1 month

GIS-TP1 Technical Specifications

Ticket Printer Features

- 58mm thermal receipt printer
- Configure business name
- Configure greeting message
- Access code is 6 digits
- Data connection is Ethernet

NOTE:

A tablet computer is required to operate the ticket printer via the ticket interface (not supplied)

Ethernet

- LAN RJ-45 10/100

Operation

- Suitable for installation in any business environment

Dimensions & Power

- 15cm x 23cm x 13cm
- 12v 110v/220v supply 12W

Warranty

- 1 year for product defects

Coffee Shop

Thank you for visiting Coffee Shop.
Your code for Internet access is:

1D 0H 0M

AGL5TX

Please visit us again soon and try our delicious home baked pastries.

Call 1-800-213-0106 for further information, or see our website: www.guest-internet.com
Fire4 Systems Inc, Guest Internet Solutions, Unit C-12, 6073 NW 167 St., Miami, FL 33015,